

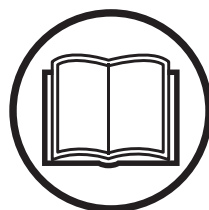

**Operator's manual**  
**Manuel d'utilisation**  
**Manual de instrucciones**  
**QC 120 QC 330**



Please read the operator's manual carefully and make sure you understand the instructions before using the machine.

Lire attentivement et bien assimiler le manuel d'utilisation avant d'utiliser la machine.

Lea detenidamente el manual de instrucciones y asegúrese de entender su contenido antes de utilizar la máquina.

**English (3-4)**

**French (5-7)**

**Spanish (8-9)**

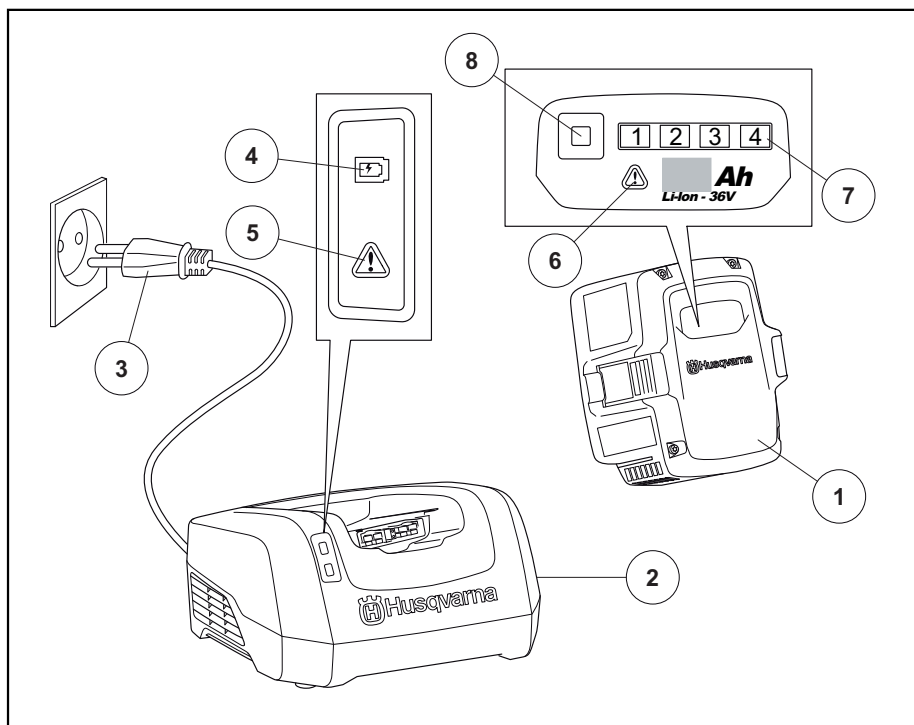

# BATTERY HANDLING

## SAVE THESE INSTRUCTIONS

### Key to symbols

Translation of the original Swedish operating instruction.

**WARNING!** Incorrect or careless use of a charger can turn it into a dangerous tool that can cause serious or even fatal injury. It is extremely important that you read and understand the contents of the operator's manual.



Please read the operator's manual carefully and make sure you understand the instructions before using the machine.



Symbols on the product or its packaging indicate that this product cannot be handled as domestic waste. This product must be deposited at an appropriate recycling facility.



Do not leave or store the battery charger outdoors in the rain or in wet conditions.



Use and store battery charger only indoors.



## Battery and battery charger

This section describes the battery and battery charger safety for your battery product.

(1) to (8) refer to the figure on page 2.

Only use Husqvarna original batteries for Husqvarna products and only charge them in an original battery charger from Husqvarna. The batteries are software encrypted.

## IMPORTANT SAFETY INSTRUCTIONS

### Battery charger

The battery chargers, QC (2), are only used for fast charging of Husqvarna replacement batteries, (1).

- This manual contains important safety and operating instructions for battery charger Model QC330 and QC120.
- Before using battery charger, read all instructions and cautionary markings on battery charger, and product using battery.
- **CAUTION!** Charge only Husqvarna Li-on Batteries. Other types of batteries may burst causing personal injury and damage.
- If the shape of the plug does not fit the power outlet, use an attachment plug adapter of the proper configuration for the power outlet.



**WARNING! Minimise the risk of electric shock or short circuit as follows:**

**Never insert any object into the charger's cooling slots. Do not try to dismantle the battery charger. Never connect the charger terminals to metal objects as this can short circuit the battery charger. Use approved and intact wall sockets.**

- Regularly check that the battery charger connection wire is intact and that there are no cracks in it.
- Never carry the battery charger using the cord and never pull out the plug by pulling the cord.
- Keep all cords and extension cords away from water, oil and sharp edges. Make sure the cord is not pinched in doors, fences or the like. Otherwise it can cause the object to become live.
- Never clean the battery or the battery charger with water.
- This appliance is not intended for use by children and other persons whose physical, sensory, or mental capabilities or lack of experience and knowledge prevents them from using the appliance safely without supervision or instruction by a responsible person to ensure that they can use the appliance safely. Children should be supervised by a responsible person to ensure that they do not play with the appliance.



**WARNING! Do not use the battery charger close to corrosive or flammable materials. Do not cover the battery charger. Pull out the plug to the battery charger in the event of smoke or fire. Risk of fire.**

- Use the battery charger only when the surrounding temperature is between 5 °C (41 °F) and 40 °C (104 °F). Use the charger in an environment which is well ventilated, dry and free from dust.

Do not use:

- a faulty or damaged battery charger
- the battery in the battery charger outdoors.

# BATTERY HANDLING

Do not charge:

- or never use a faulty, damaged or deformed battery.
- non-rechargeable batteries in the battery charger or use them in the machine.
- the battery in the rain or in wet conditions.
- the battery in direct sunlight.

## Operation



**WARNING! Risk of electric shock and short circuiting. Use approved and intact wall sockets. Make sure that the cable is not damaged. Replace cable if it appears to be damaged in any way.**

## Connect the battery charger

- Connect the battery charger to the voltage and frequency specified on the rating plate. Put the electric plug in a earthed socket-outlet. The LED on the battery charger flashes green once. (4)

## Connect the battery to the battery charger

The battery must be charged before using it the first time. The battery is only 30% charged when delivered.

- Put the battery in the battery charger. Make sure that the battery is connected to the battery charger. (1), (2)
- The green charging light on the charger is lit when the battery is connected to the battery charger. The battery will not be charged if the battery temperature is over 50 °C (122 °F). In that case the battery charger will actively cool down the battery. (4)
- When all LEDs are lit the battery is fully charged. (7)
- Remove the battery from the battery charger.
- Pull out the plug. Never jerk the power supply cable to disconnect it from the wall socket. (3)

## Transport and storage

- Store the equipment in a lockable area so that it is out of reach of children and unauthorized persons.
- Store the battery and the battery charger in a dry, moisture-free and frost-free space.
- Store the battery and the battery charger where the temperature is between 5 °C (41 °F) and 45 °C (113 °F) and never in direct sunlight.
- Store the battery charger only in an enclosed and dry space.
- Be sure to store the battery separate from the battery charger.

## Maintenance

Make sure the battery and battery charger are clean and that the terminals on the battery and the battery charger are always clean and dry before the battery is placed in the battery charger.

Keep the battery guide tracks clean. Clean plastic parts with a clean and dry cloth.

## Fault codes

Troubleshooting the battery and/or the battery charger during charging.

(5), (6)

LED display	Possible faults	Possible action
Error LED flashing	Temperature deviation	Use the battery in surroundings where temperatures are between -10 °C (14 °F) and 40 °C (104 °F).
Error LED is lit	Cell difference too much (1V)	Contact your service agent.

- If the LED on the battery charger is lit solid red, the battery charger requires a service. (5)

## Disposal of the battery, battery charger and machine

Symbols on the product or its packaging indicate that this product cannot be handled as domestic waste. It must instead be submitted to an appropriate recycling station for the recovery of electrical and electronic equipment.

By ensuring that this product is taken care of correctly, you can help to counteract the potential negative impact on the environment and people that can otherwise result through the incorrect waste management of this product. For more detailed information about recycling this product, contact your municipality, your domestic waste service or the shop from where you purchased the product.

## Technical data

Technical data		
Battery charger	<b>QC120</b>	<b>QC330</b>
Input Voltage, V	100-120	100-240
Frequency, Hz	60	50-60
Power, W	125	330

The following standards have been applied:

### Safety standards:

IEC 60335-2-29:2009 (fourth edition) +A1:2004+A2:2009 in conjunction with IEC 60335-1:2001 (fourth edition) inc. Corrigendum 1:2002+A1:2004+A2:2006 incl. Corrigendum 1:2006.

UL/CSA 60335-1/60335-2-29 + C 22.2 No 223

### EMC+FCC Standards:

EN 61204-3:200, EN 61000-3-2:2006+A1:2009+A2:2009, EN 61000-3-3:2008.